

30,166 SF with Trailer Parking - For Lease
Delivered with Capital Improvements

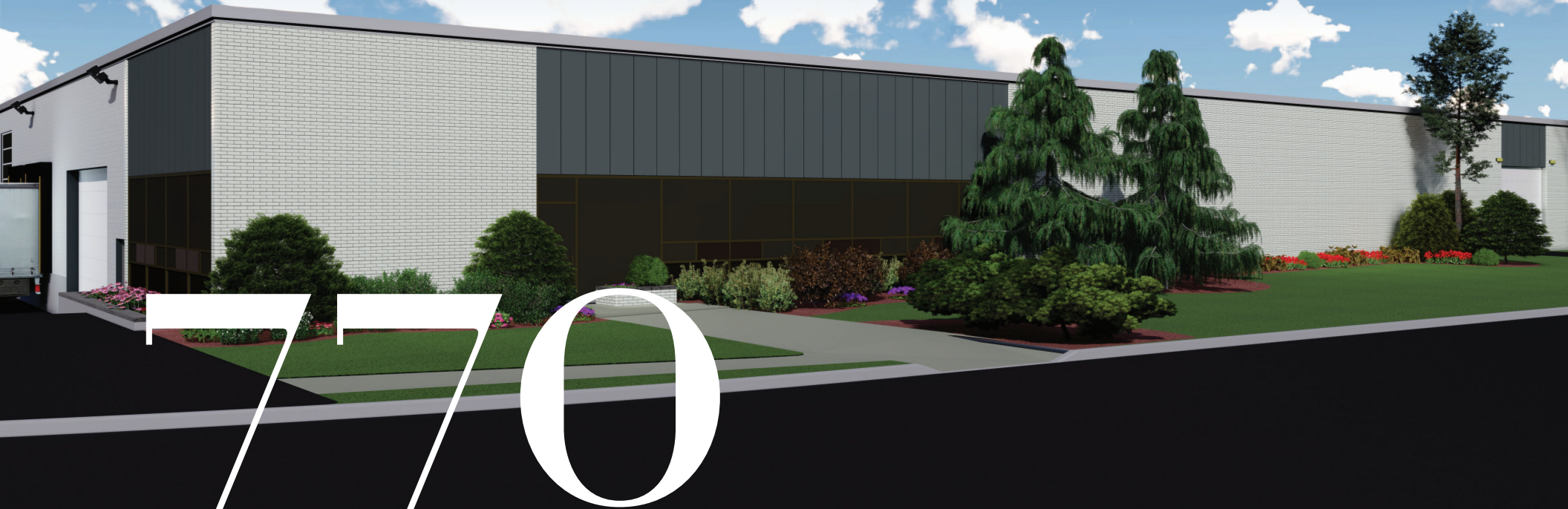

70

Commercial Avenue

Carlstadt, NJ 07072



770

Commercial Avenue

Space Features

Warehouse	28,300 SF
Office	1,866 SF
Loading Docks	4
Drive-in Door	1
Parking	Approx. 1 acre
Ceiling Height	17.5'
Column Spacing	50'x30'

Renovations Underway

- New office
- New Dock Doors
- Bathroom Renovations
- Warehouse Whitebox
- New Asphalt/Trailer Parking
- Facade Enhancements

Comments

- Functional Single Tenant Building with 4 Docks
- 150' + Truck Court
- Low Coverage Building Equipped with 9 Trailer Stalls
- 3.1 Miles from I-95 with Excellent Access to New York, Direct Access to Manhattan via the George Washington Bridge & Lincoln Tunnel
- Professionally Owned & Managed

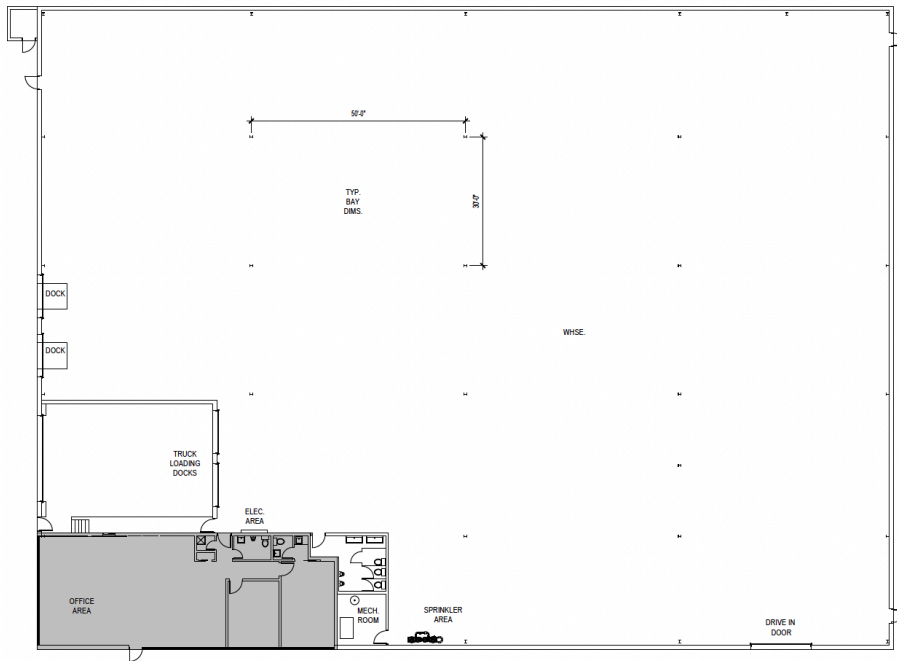

770

Commercial Avenue



Noah Balanoff

Vice Chair
Salesperson

noah.balanoff@colliers.com

+1 973 299 3023

Frank Gunsberg

Executive Vice President
Broker Salesperson

frank.gunsberg@colliers.com

+1 973 299 3088

Jacquelyn Severino

Associate Vice President
Salesperson

jacquelyn.severino@colliers.com

+1 973 299 3081

Mark Hay

Vice President
Salesperson

mark.hay@colliers.com

+1 973 299 3002

770

Commercial Avenue

Carlstadt, NJ 07072



No representation is made as to the accuracy of the information furnished herein and same is submitted subject to errors, omissions, change of prices, rental, or other conditions, prior sale, lease, sublease, and/or withdrawal without notice. While every attempt is made to ensure accuracy, the floor plan(s) is for guidance only. The measurements, dimensions, specifications, and other data shown are approximate and may not be to scale. We assume no responsibility for the accuracy of the floor plan(s) or for any action taken in reliance thereon. The floor plan(s) do not create any representation, warranty or contract. All parties should consult a professional, such as an architect, to verify the information contained herein. The furnishing of this information shall not be deemed a hiring. A commission in accordance with our principal's schedule of rates and conditions will be paid to the procuring Broker who executes our or our principal's brokerage agreement, subject to a fully consummated transaction upon terms and conditions acceptable to our principal. Colliers International NJ, LLC