

FOR LEASE OR SALE

151,474 SF

25.3 Acres
Additional Land

STURTEVANT, WI

3535 OAKES ROAD

LEASE RATE

\$4.95 Net

SALE PRICE

Subject To Offer

COMMENTS

- Building Features LED Warehouse Lights and is in Move-in Condition
- 5 Acre Secured Concrete Fenced Area in for Either Outdoor Storage, Car Parking or Trailer Parking
- Additional 25.3 Acres Available For Development, Outside Storage or Truck Parking
- Within Minutes of I-94 and Strategically Located for Access to Chicago and Milwaukee
- Pro-Business Climate
- Professionally Owned and Managed

BUILDING DETAILS

| | |
|------------------|--|
| Building Size | 151,474 SF |
| Office Size | 8,372 SF |
| Warehouse Office | 1,272 SF |
| Loading | 6 Exterior Docks 2 Drive-In Doors (14' x 16') |
| Clear Height | 21.5' |
| Car Parking | 32 (Expandable to 300+ Cars) |
| Trailer Parking | 112 Stalls |
| Power | 1200 Amps, 480 V, 3-Phase |
| Sprinkler | ESFR |

Brokered by:

ENTRE
Commercial Realty LLC

Owned & Managed by:

VentureOne

FOR LEASE OR SALE

151,474 SF

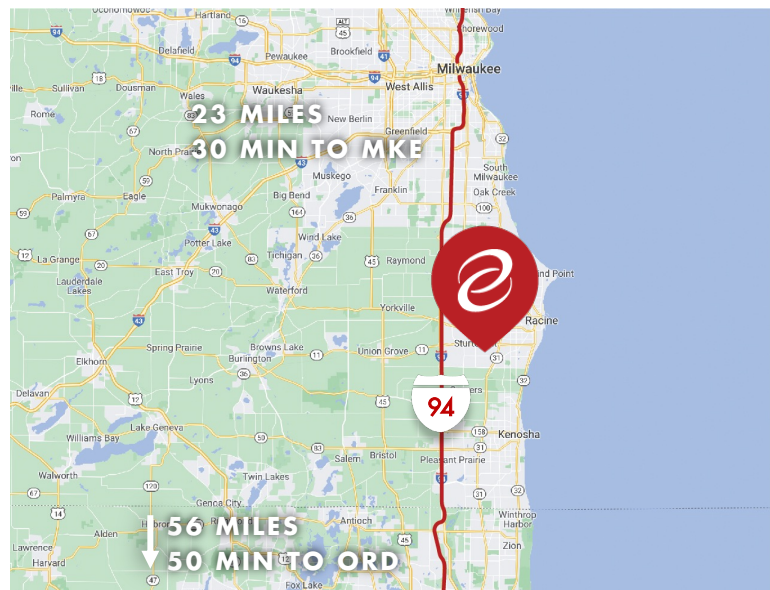
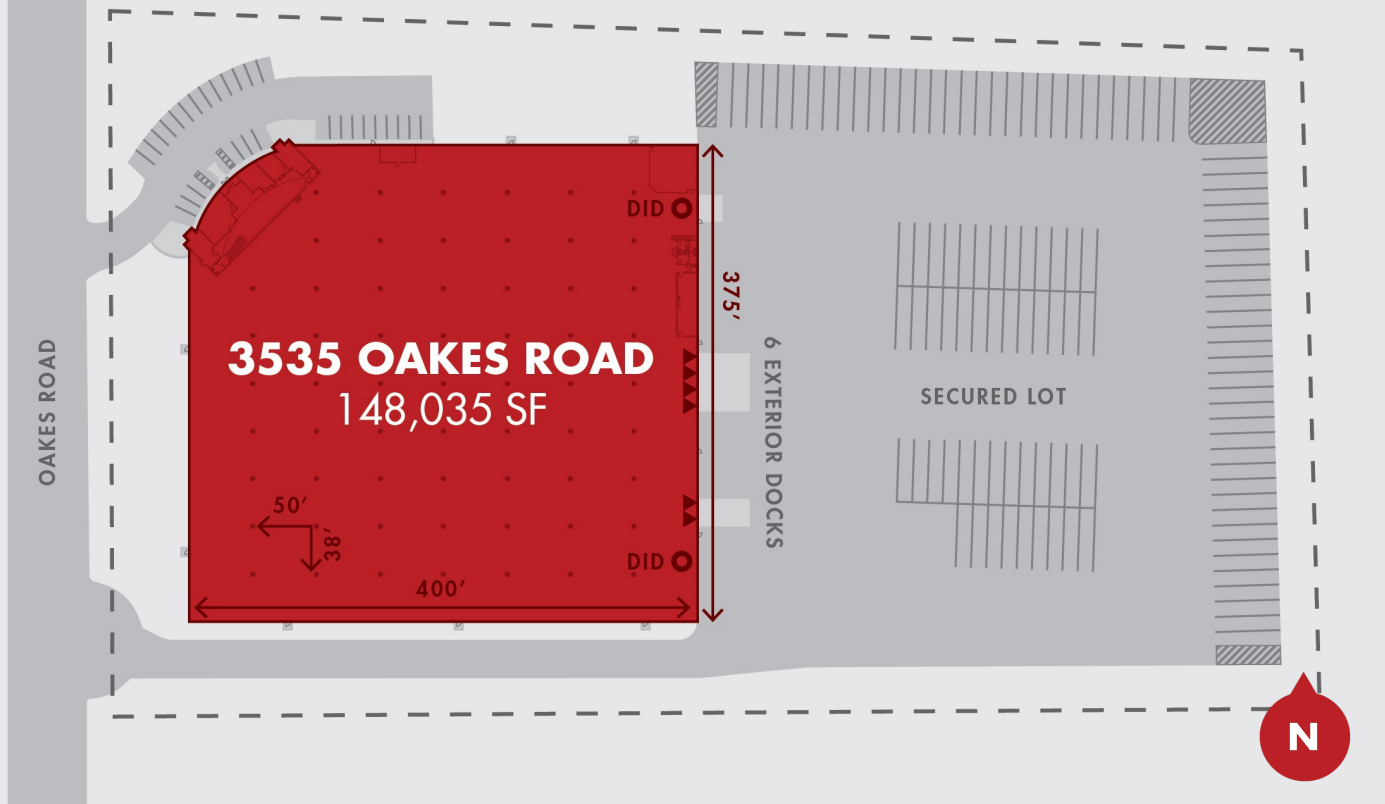

BRIAN BOCCI

Entre Commercial Realty LLC
BBocci@EntreCommercial.com
847-310-4296

KYLE GRANT

Venture One Real Estate
KyleG@VentureOneRE.com
847-495-4615

