

2720 Bartram Road, Bristol, PA

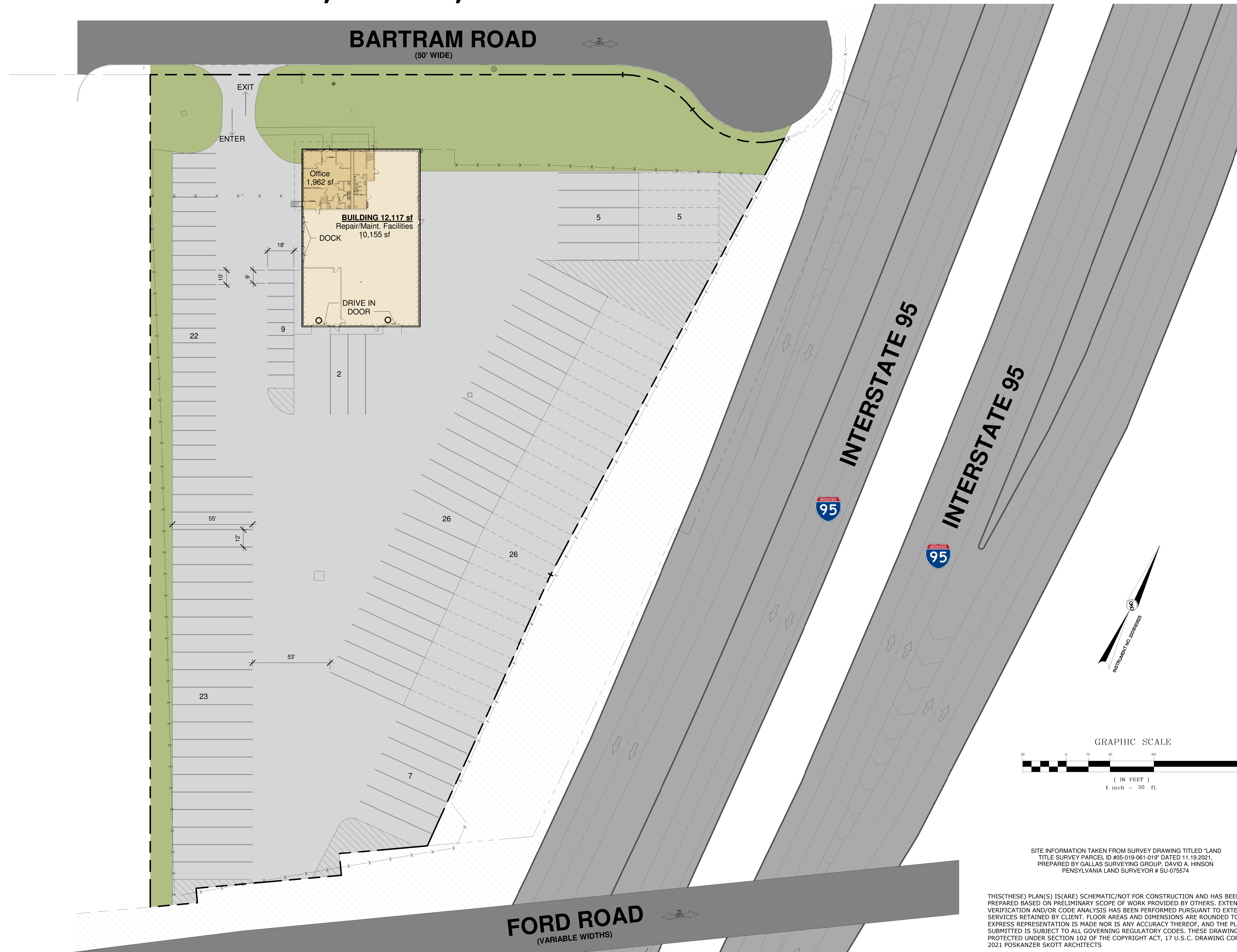

BUILDING AREAS

REPAIR / MAINT. FACILITIES	10,155 SF
OFFICES	1,962 SF
TOTAL	12,117 SF

PARKING INFO (SPACES)

TRAILERS (12'-0" X 55'-0")	94
Regular 63 - Tandem 31	
SPRINTER VANS (10'-0" X 30'-0")	22
CAR PARKING (9'-0" X 18'-0")	9

LOADING

LOADING DOCKS	2
DRIVE-IN DOOR	2



Scale: 1" = 30'-0"

Drawing Title
PARKING LAYOUT - TRAILERS

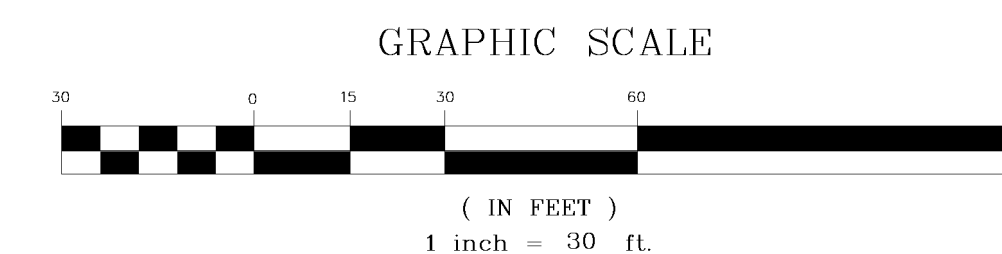

SITE INFORMATION TAKEN FROM SURVEY DRAWING TITLED "LAND TITLE SURVEY PARCEL ID #05-019-061-019" DATED 11.19.2021, PREPARED BY GALLAS SURVEYING GROUP, DAVID A. HINSON PENNSYLVANIA LAND SURVEYOR # SU-075574

THIS(THESE) PLAN(S) IS(ARE) SCHEMATIC/NOT FOR CONSTRUCTION AND HAS BEEN PREPARED BASED ON PRELIMINARY SCOPE OF WORK PROVIDED BY OTHERS. EXTENT OF FIELD VERIFICATION AND/OR CODE ANALYSIS HAS BEEN PERFORMED PURSUANT TO EXTENT OF SERVICES RETAINED BY CLIENT. FLOOR AREAS AND DIMENSIONS ARE ROUNDED TO ± 6". NO EXPRESS REPRESENTATION IS MADE NOR IS ANY ACCURACY THEREOF, AND THE PLAN SUBMITTED IS SUBJECT TO ALL GOVERNING REGULATORY CODES. THESE DRAWINGS ARE PROTECTED UNDER SECTION 102 OF THE COPYRIGHT ACT, 17 U.S.C. DRAWING COPYRIGHT © 2021 POSKANZER SKOTT ARCHITECTS

Poskanzer Skott Architects
550 North Maple Avenue
Ridgewood, NJ 07450
Telephone: 201-445-2322
Facsimile: 201-445-3053
E-mail: www.poskanzerskott.com

Project 2161
Date 11/29/21
Rev BP

MK1.1

2720 Bartram Road, Bristol, PA



BUILDING AREAS

REPAIR / MAINT. FACILITIES	10,155 SF
OFFICES	1,962 SF
TOTAL	12,117 SF

PARKING INFO (SPACES)

SPRINTER VANS (10'-0" X 30'-0")	193
Regular 182 - Tandem 11	
CAR PARKING (9'-0" X 18'-0")	8

LOADING

LOADING DOCKS	2
DRIVE-IN DOOR	2



Scale: 1" = 30'-0"

Drawing Title
**PARKING LAYOUT -
SPRINTER VANS / DELIVERY
TRUCKS**

**Poskanzer Scott
Architects**
550 North Maple Avenue
Ridgewood, NJ 07450

Telephone: 201-445-2322
Facsimile: 201-445-3053
E-mail: www.poskanzerscott.com

Project 2161
Date 11/29/21
Rev BP

MK1.2

SITE INFORMATION TAKEN FROM SURVEY DRAWING TITLED "LAND
TITLE SURVEY PARCEL ID #05-019-061-019" DATED 11.19.2021.
PREPARED BY GALLAS SURVEYING GROUP, DAVID A. HINSON
PENNSYLVANIA LAND SURVEYOR # SU-075574

THIS(THESE) PLAN(S) IS(ARE) SCHEMATIC/NOT FOR CONSTRUCTION AND HAS BEEN
PREPARED BASED ON PRELIMINARY SCOPE OF WORK PROVIDED BY OTHERS. EXTENT OF FIELD
VERIFICATION AND/OR CODE ANALYSIS HAS BEEN PERFORMED PURSUANT TO EXTENT OF
SERVICES RETAINED BY CLIENT. FLOOR AREAS AND DIMENSIONS ARE ROUNDED TO ± 6". NO
EXPRESS REPRESENTATION IS MADE NOR IS ANY ACCURACY THEREOF, AND THE PLAN
SUBMITTED IS SUBJECT TO ALL GOVERNING REGULATORY CODES. THESE DRAWINGS ARE
PROTECTED UNDER SECTION 102 OF THE COPYRIGHT ACT, 17 U.S.C. DRAWING COPYRIGHT ©
2021 POSKANZER SKOTT ARCHITECTS